

# DXB

---

35M (114'10") | BENETTI | 2003/2024



# THE IDEAL YACHT CHARTER ADVENTURE

---

Built in 2003 and refitted in 2024, DXB is the perfect yacht for kicking back and relaxing while on charter, showcasing clever use of space. With an artful combination of integrated systems and exceptional features, she is sure to please any crowd. If excitement on the water is what you seek, DXB comes equipped with a range of accessories and water toys to keep charter guests entertained all day long. DXB is a unique motor yacht and the ideal platform for a charter adventure that guarantees unforgettable memories.





# WELCOME ONBOARD

---

The tri-deck DXB, designed by Stefano Righini, offers exceptional exterior living spaces. The main deck aft boasts a spacious alfresco dining area with direct access to the salon, perfect for both formal gatherings and casual entertainment. Moving up to the upper deck, adjacent to the sky lounge, guests can enjoy another alfresco dining setting under overhead shade, complemented by luxurious exterior furnishings.



MAIN DECK AFT SEATING AREA



UPPER DECK AFT



**UPPER DECK AFT SEATING AREA**









**UPPER DECK AFT AL-FRESCO DINING AREA**







STAIRCASE

The sundeck has been reconfigured to accommodate a spacious seating area and features a new teak deck. This partially shaded space offers various amenities, including a wet bar, alfresco dining area, chaise loungers, ample seating, and a deluxe Jacuzzi tub - perfect for enjoying the scenery with your favourite drink in hand. At the stern of DXB, dual steps lead to the swim platform, providing easy access to the water. Adjacent to this, there is a large water toy garage housing an extensive collection of water toys, including a brand new 6.85m tender acquired in 2024.









**SUN DECK JACUZZI**







# INTERIOR LIVING

---

DXB boasts a stunning interior styled by the renowned French designer Zuretti. The Hermes decor exudes contemporary elegance, characterised by high gloss cherry-toned woods, sumptuous soft furnishings, and a light, airy ambiance throughout. The salon lounge on the main deck provides ample relaxing seating and is adorned by panoramic windows, offering breathtaking views. Moving forward on the starboard side, guests will find the stylish formal dining area accessible via the guest foyer. Upstairs, the upper sky lounge, adorned by Ralph Lauren, offers additional seating, an inviting pantry, and a well-equipped bar.



MAIN SALON









MAIN DECK BAR



**DINING AREA**













**STAIRCASE**



UPPER DECK SALON



**UPPER DECK BAR**



STAIRCASE



# ACCOMMODATION

---

DXB offers accommodation for up to 10 guests in 5 well-appointed cabins, comprising a master suite, two double cabins, and two twin cabins. The master cabin, situated on the main deck, spans the full beam of the yacht and features a king-size bed, sofa, and a luxurious en suite bathroom with a tub and shower. On the lower deck, two guest cabins are furnished with queen-size beds, while the remaining two cabins offer side-by-side twin beds, all equipped with en suite bathrooms. In total, there are 7 beds, including 1 king, 2 queens, and 4 singles. DXB also boasts accommodation for up to 7 crew members across 4 cabins, ensuring a relaxed and enjoyable yacht charter experience.



**MASTER SUITE**











MASTER BATHROOM





DXB

Aesop





**DOUBLE CABIN**





**GUEST BATHROOM**





TWIN CABIN



DXB



**GUEST BATHROOM**

The image shows two neatly folded white towels stacked on a dark, polished wooden surface. Each towel has the letters 'DXB' printed in a bold, black, sans-serif font. The top towel is slightly offset to the left, revealing the bottom towel underneath. The wooden surface is highly reflective, creating a clear mirror image of the towels and the 'DXB' text. The background consists of dark wood paneling with vertical lines, and a textured, light-colored wall is visible on the left side. The lighting is warm and focused on the towels, highlighting their soft texture and the sharp contrast of the printed letters.

**DXB**

**DXB**





BRAND NEW 650TL



# SPECIFICATION

---

LOA: **35.00M / 114'10"**  
BEAM: **6.90M / 22'8"**  
DRAFT: **2.00M / 6'7"**  
BUILDER: **BENETTI**  
MODEL: **CLASSIC 115'**  
BUILD YEAR: **2003**  
REFIT: **2024**  
EXTERIOR DESIGNER: **STEFANO RIGHINI**  
NAVAL ARCHITECT: **BENETTI**  
INTERIOR DESIGNER: **ZURETTI**  
HULL & SUPERSTRUCTURE: **GRP**  
DECK MATERIAL: **TEAK**  
CONFIGURATION: **SEMI-DISPLACEMENT**  
GRT: **254**  
FLAG: **UNITED ARAB EMIRATES**  
CLASS: **RINA**

---

GUESTS SLEEPING: **10**  
GUESTS CRUISING: **50**  
NUMBER OF CABINS: **5**  
CABIN CONFIGURATION: **1 MASTER, 2 DOUBLE, 2 TWIN**  
BED CONFIGURATION: **1 KING, 2 QUEEN, 4 SINGLE**  
CREW: **7**

---

ENGINES: **2 X CATERPILLAR 3412E, 1,400HP**  
FUEL CAPACITY: **35,000L**  
CRUISING SPEED: **12 KNOTS**  
MAXIMUM SPEED: **16 KNOTS**  
CRUISING RANGE: **3,200 NM**



# FEATURED HIGHLIGHTS

---

- UNDERWENT A MAJOR REFIT IN 2023-2024
- LUXURIOUS AMENITIES AND EXPANSIVE SPACES ACROSS FOUR DECKS
- CLASSIC INTERIORS COMPLEMENTED BY CONTEMPORARY FEATURES AND HERMES DECOR
- MAIN DECK OPEN LAYOUT, AND TWO BIG SALONS WITH PANORAMIC VIEWS
- SPACIOUS SUN DECK FEATURING A JACUZZI, WET BAR, AND AMPLE LOUNGING AREAS
- MULTIPLE ALFRESCO DINING OPTIONS ON THE MAIN AND UPPER DECK
- PERFECT FAMILY YACHT WITH 5 GENEROUS CABINS FOR UP TO 10 GUESTS
- MASTER SUITE LOCATED ON THE MAIN DECK, WITH FULL-BEAM LAYOUT
- CAPABLE OF HOSTING UP TO 50 GUESTS DURING EVENT CHARTERS
- EXPERIENCED AND CHARTER-ORIENTED CAPTAIN AND CREW
- BRAND NEW 6.85M TENDER FROM 2024

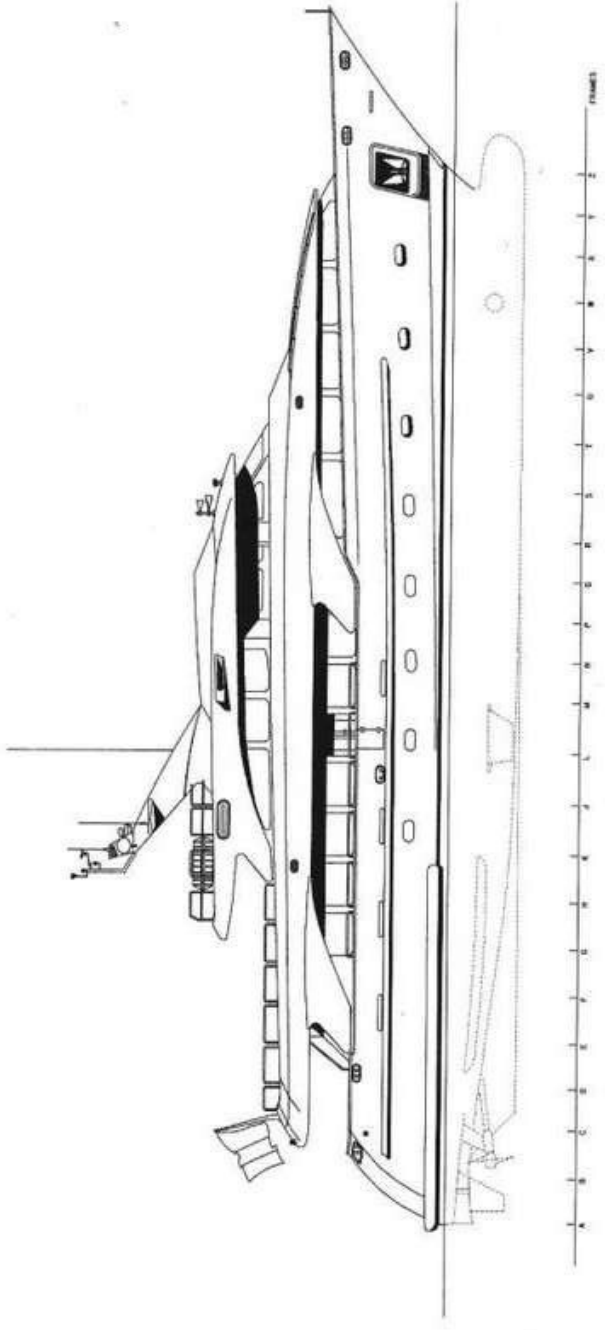

BC007

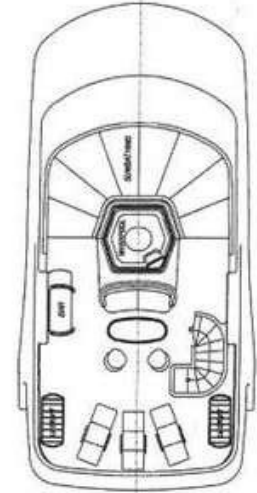

SUN DECK

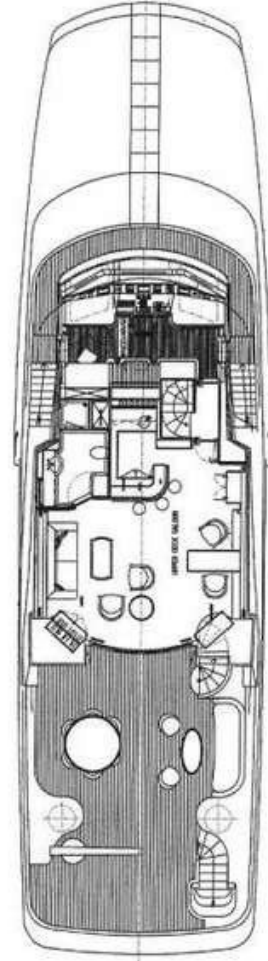

UPPER DECK

BC007

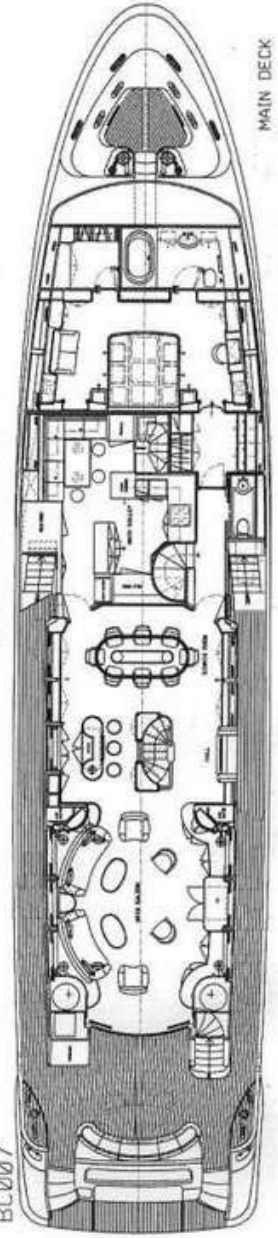

MAIN DECK

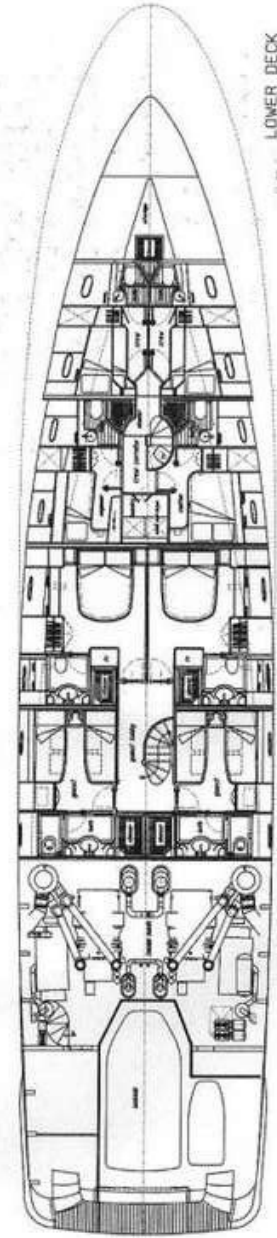

LOWER DECK

# GENERAL ARRANGEMENT



